



The Creative Life

- Before using your washing machine, please read this manual carefully and keep it for future reference.
- The drawings in this manual are for instruction only, they may vary from the model you buy
- This manual is also available online.

Washing Machine Owner's Manual

Inside you will find many helpful hints on how to use and maintain your washing machine properly. Just a little preventative care on your part can save you a great deal of time and money over the life of your washing machine. You'll find many answers to common problems in the chart of troubleshooting tips. If you review the chart of Troubleshooting Tips first, you may not need to call for service.

Contents

Product Specification	01
Safety Information	02
Usage Cautions.....	05
Important Hints.....	06
Your washing machine.....	07
Installation.....	08
Operations.....	12
Maintenance.....	19
Troubleshooting.....	21
Appendix.....	23
Australian lay-out test supplement	25

Product Specification

Model	WF75P10W
Net Weight	7.5kg
Voltage	220-240V~/50Hz
Water Pressure	0.05-0.8MPa
Rated Power	1900W
Outer Dimension (W*D*H)	595*520*850mm
Net(kg)	58

Note: Our Company reserves the right to change the design of the product. The product you purchase may have been improved, and may not be exactly the same as that indicated herein. However, the performance and usage of the product remain the same.

Safety Information

WARNING

To reduce the risk of fire,electric shock,or injury to persons , read entire Owner's manual and follow the Important Safety Instructions and basic precautions,including the following before operating this washer.

- If the power cord is damaged,it must be replaced by the manufacturer, service agent or similarly qualified persons in order to avoid the hazard.
- The new hose-sets supplied with the washer are to be used and that old hose-sets should not be reused.
- This appliance is not intended for use by persons(including children)with reduced physical,sensory or mental capabilities,or lack of experience and knowledge,unless they have been given supervision or instruction concerning use of the appliance by a person responsible for their safety.Children should be supervised to ensure that they do not play with the appliance.
- This appliance can be used by children aged from 8 years and above and persons with reduced physical,sensory or mental capabilities or lack of experience and knowledge if they have been given supervision or instruction concerning use of the appliance in a safe way and understand the hazards involved.Children shall not play with the appliance.Cleaning and user maintenance shall not be made by children without supervision.
- The washing machine must not be placed on carpet as it may block the ventilation opening on the base.
- Children of less than 3 years should be keep away unless continuously supervised.
- This appliance is intended to be used in household and similar applications such as:
 - staff kitchen areas in shops,offices and other working environments;
 - farm houses
 - by clients in hotels,motels and other residential type environments;
 - bed and breakfast type environments;
 - areas for communal use in blocks of flats or launderettes.
- Take care that power voltage and frequency shall be identical to those of washing machine.
- To ensure your safety,power cord plug must be inserted into an earthed socket. Check carefully and make sure that your socket is proper and earthed reliably.
- Do not use any socket with rated current less than that of washing machine.
- Do not operate your washer when parts are missed or broken.
- Never pull out power plug with wet hands.

Safety Information

- Unplug your washer before cleaning or making any repair.
- Please check whether the water inside the drum has been drained before opening the door. Please do not open the door if there is any water visible.
- Glass door may be very hot during the operation. Keep kids and pets far away from the washer during the operation.
- Make sure that the water and electrical device are connected by a qualified technician in accordance with the manufacturer's instruction and local safety regulations.
- Before operating this machine, all packages and transit bolts must be removed. Otherwise, the washing machine may be seriously damaged while washing the clothes.
- Flammable and explosive or toxic solvents are forbidden. Gasoline and alcohol etc. shall not be used as detergents. Please only select the detergents suitable for machine washing.
- Be careful of scalding while the washer is draining hot washing water.
- Never unplug your washer by pulling on the supply cord. Always grasp the plug firmly and pull straight out from the outlet.
- Packing materials may be dangerous to the kids. Please dispose of all packing materials (plastic bags, foams etc) safely away from the kids.
- Do not climb up and sit on top cover of the machine.
- Pets and kids may climb into the machine. Check the machine before every operation.
- Do not lean against the door of the washer.

Safety Information

WARNING

To reduce the risk of fire, electric shock, or injury to persons when using your appliance, follow basic precautions, including the following:



FORBIDDEN

Contents marked with this symbol are actions forbidden. Performing of those actions may result in damage of the machine or injure the personal safety of the user.

- ⊗ 1. Please do not damage power flexible cord and power plug to avoid electric shock, short circuit and catching fire.
- ⊗ 2. Please do not pull out or insert the plug with wet hands to avoid electric shock.
- ⊗ 3. Please do not disassemble and re-assemble the machine without authorization.
- ⊗ 4. Please do not wash padded jacket, raincoat, fishing coat and similar clothes in the washer.
- ⊗ 5. Please do not let children climb the machine or peer into the rotating spin barrel to avoid accidents.
- ⊗ 6. Please do not install the machine in damp and raining environment to avoid electric shocking, catching fire, faults and distortion accidents.
- ⊗ 7. It is strictly prohibited to place and sit children or lay weights on the washer.
- ⊗ 8. Do not turn the appliance off by unplugging the power plug while the washer is in operation. Plugging the power plug into the wall socket again may cause a spark and result in electric shock or fire.



NOTICE

Contents marked with this symbol are related to the safety of the product and the personal safety of the users. Please operate in strict conformity to the contents, otherwise it may cause damage of the machine or injure the personal safety of the user.

- ☺ 1. Please use correct power source. Turn off the water faucets and unplug the washer if the machine is to be left for an extended period of time, such as during vacations.
- ☺ 2. Please put the clothes evenly into the washing machine, clothes placed unevenly will produce noise or vibration. Can not be hot, heavy objects (such as hot kettle, iron) is put in the washing machine.
- ☺ 3. It is prohibited to wash the clothes touching with kerosene, gasoline, alcohol and other flammable materials.
- ☺ 4. The water temperature shall not exceed 55 °C when washing with warm water.
- ☺ 5. The machine must away from direct sunlight or heat source just like a heater.



GROUNDING

This appliance must be grounded. In the event of malfunction or breakdown, grounding will reduce the risk of electric shock by providing a path of least resistance for electric current.

Usage Cautions

CAUTION

- ⊙ 1. Your washing machine is for house use. Your washing machine can only wash for machine washable fabrics. Use the washer only for its intended purpose as described in this owner's Manual. Before use, the washer must be properly installed as described in this manual.
- ⊙ 2. To prevent personal injury or strain, wear protective gloves whenever lifting or carrying the unit.
- ⊙ 3. If a drain error occurs during an operation, check if there is a draining problem. If the washer is used when it is flooded because of a draining problem, it may result in electric shock or fire due to electric leakage.
- ⊙ 4. To minimize the possibility of electric shock, unplug this appliance from the power supply before attempting any maintenance or cleaning.
- ⊙ 5. If the water supply hose comes loose from the faucet and floods the appliance, unplug the power plug. Failing to do so may result in electric shock or fire.
- ⊙ 6. Store and install the washer where it will not be exposed to temperatures below freezing or exposed to outdoor weather conditions. Failure to follow this warning can cause serious leak damage.

WARNING

- ⊙ 1. Do not leave metal objects (safety pins, hair pins, etc.) or bleach in the tub for long periods of time. This may cause the tub to rust. If rust appears on the surface of the tub, apply a neutral cleansing agent to the surface and use a sponge to clean it. Never use a metal brush.
- ⊙ 2. Do not wash articles that have been previously cleaned in, washed in, soaked in, or spotted with gasoline, dry cleaning solvents, or other flammable or explosive substances, as they give off vapors that could ignite or explode.
- ⊙ 3. Do not place items exposed to cooking oil in your washer. Items contaminated with cooking oils may contribute to a chemical reaction that could cause a load to catch fire.
- ⊙ 4. Please do not place on the washer burning candles, mosquito-repellent incense, cigarette and other flammable things, as well as electric stove, air heating fan and other heating sources, they may damage the surface.
- ⊙ 5. Please do not insert your hand and take out clothes inside the spin barrel before it is fully stopped.
- ⊙ 6. Do not use normal hand-washing soap in the washer. If it hardens and accumulates inside the washer, it may cause problems with the product, discoloration, rust, or bad odors.
- ⊙ 7. Do not wash large laundry items such as bedding in the washing net. Failing to do so may result in injury due to abnormal vibrations. Place smaller items, such as lace socks and lingerie in the washing net.
- ⊙ 8. Do not place any non-laundry objects, such as shoes, food waste, or animals into the washer. This can cause abnormal vibrations that can damage the washer, and, in the case of pets, cause severe injury or death.

Usage Cautions

DANGER

1. Keep laundry products out of children's reach. To prevent injury to persons, observe all warnings on product labels. Failure to comply with these warnings could result in serious injury to persons or death. If a child places a bag over their head, the child may suffocate.
Destroy the carton, plastic bag, and other packing materials after the washer is unpacked. Children might use them for play. Cartons covered with rugs, bedspreads, or plastic sheets can become airtight chambers. Failure to comply with these warnings could result in serious injury to persons or death.
2. If the appliance is flooded, cut the power immediately and disconnect the water supply, and contact your nearest service center. If the appliance emits a strange noise, a burning smell, or smoke, unplug the power plug immediately and contact your nearest service center. Failing to do so may result in electric shock or fire. Do not stand in water while disconnecting appliance.
3. Do not attempt to repair, disassemble, or modify the appliance yourself. Do not use any fuse (such as copper, steel wire, etc.) other than the standard fuse. If you need to repair or reinstall the appliance, contact your nearest service center. Failing to do so may result in electric shock, fire, problems with the product, injury and may void warranty.

Important Hints

- The household washing machine isn't intended to be built-in.
- This washing machine is for indoor using only.
- Make sure that all pockets are empty. Sharp and rigid items such as coins, brooches, nails, screws or stones etc. May cause serious damage to the washer.
- Please remember to disconnect water and power supply immediately after the clothes are washed.
- The washing machine shall not be installed in bath rooms or very wet areas, as well as in the rooms with explosive or caustic gases.
- Before washing clothes for the first time, the washing machine shall be operated with a full cycle without clothes inside.
- Repair or replacement of any part of the washer are to only be carried out by the manufacturer or authorised TCL service centre.
- It is not recommended to wash mats and bras and bras inset with steel wire. It is recommended bras with steel wire are placed in a laundry bag.
- Never refill water by hand during washing.
- After the program is completed, please wait for two minutes to open the door.
- When handing the machine, the accumulated water shall be drained out of the machine first. Handle the machine carefully. Never hold each protruded part on the machine while lifting. The machine door can not be used as the handle during transportation.
- Washing machines with single inlet valve only can be connected to the cold water supply. Washing machines with double inlet valves can be connected to the hot water and cold water supply.

SAVE THESE INSTRUCTIONS

THIS MACHINE IS FOR HOUSEHOLD USE ONLY

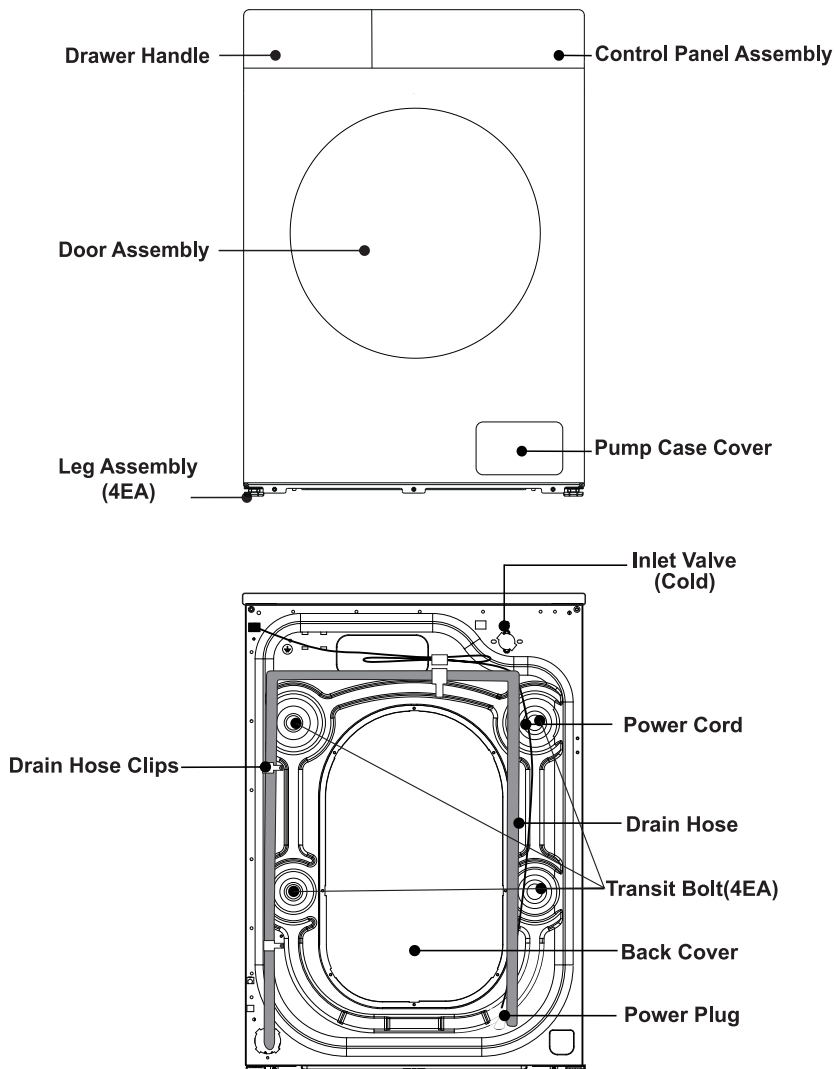

* The illustration is a simple example of the model control panel.
The illustration is for reference only. Please refer to your actual product.

Installation

 **NOTE**

We recommend that your new washer is installed by a qualified appliance technician.If you feel that you have the skills to install the washer, please read the installation instructions carefully before installing.





■ Tools needed

You may need to have the following tools in order to install your new washer:

- Scissors
 - Gloves
- Pliers
 - Spanner
- Standard Screwdriver

■ Unpacking the washing machine

Unpacking your washing machine and check if is there any damage during the transportation. Also make sure that all the the items(as shown below) in the attached bag are received. If there is any damage to the washing machine during the transportation,or any item is missing or damaged,please contact your place of purchase immediately.

Cold Water Hose (Connect to cold water supply)	Hole Cover (4EA) (Used to plug transit bolt holes)	Drain Hose Support Bracket (Used to loop the end of drain hose)	Spanner (1.Used to adjust the bottom of the machine, 2.Remove the transport bolt on the back of the machine)
			

■ Select the location

Before installing the washer,the location characterized as follows shall be selected:

- Rigid,dry,and level surface(if not level,please make it level with reference to the following figure “Adjustable Leg”).
- Avoid direct sunlight.
- Sufficient ventilation.
- The ambient temperature should be between 0-40°C.
- The ambient humidity shall be below 95%(When the temperature is 25°C).
- Keep far away from the heat resources such as coal or gas.Make sure that the washer will not stand on power cord.Do not install the washer on the carpet floor.

Installation

■ Remove transit bolts

Before using this washing machine, transit bolts must be removed from the backside of this machine. Please take the following steps to remove the bolts:

⚠ Keep the transit bolts safe for future use.

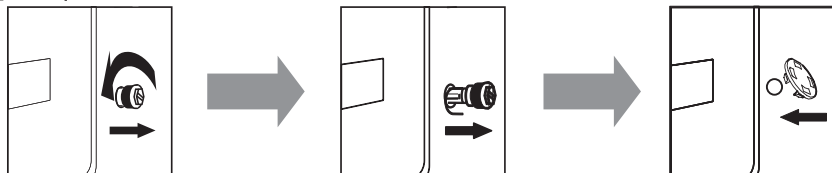

1. Loosen the four transit bolts with a spanner.
2. Take each bolt head and pull it through the wide part of the hole. Repeat for each bolt.
3. Fill the holes with the supplied plastic covers.

■ Level the washing machine

Install or place the washing machine under the environmental temperature of not less than 0°C but not outdoors, for it may damage the programming controller.

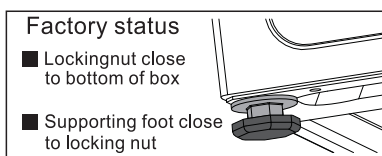
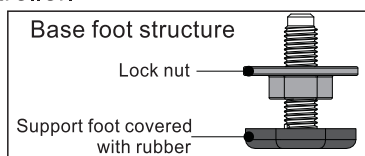

⚠ **Note:** In order to facilitate installation, the factory status of the foot may not be all locked, please be sure to lock all four feet before adjusting the level

1. When placing the machine, check whether the bottom foot is in the factory state. If not, please restore the bottom foot to the factory state: the locking nut is locked tightly on bottom of the box, and the support foot is locked tightly on the locking nut.

2. After the machine is placed, press the opposite corner of the top cover plate of the washing machine with both hands in turn and shake it vertically downward to check whether the supporting foot is close to the ground and whether the machine moves.

3. To ensure that the machine is placed in the right state, loosen the locking nut according to the direction shown in the diagram with the attached spanner to the appropriate height until the supporting foot is close to the ground and the machine is free from movement.

4. Finally, use the spanner to turn the lock nut back to the bottom of the box to lock it (you can also slightly fix the support foot by hand to avoid the support foot moving again).

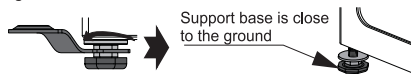

⚠ CAUTION

1. The machine must be perfectly leveled and stabilized when the four supporting feet are close to the ground. Lower the feet as much as possible on the basis that the machine is leveled.
2. Improper leveling adjustment may cause loud noise, machine vibrating, machine displacement and other abnormal phenomena.
3. The Air vent is located on the bottom of the machine, please prevent any blockage. Install the washing machine on solid, smooth and skid-proof ground. Do not place the washing machine on soft blankets, wooden floor or desktops/stand. This will prevent unnecessary injury.

Installation

The provided water hose may differ depending on the model. Please follow the instruction according to the provided water hose.

■ Connect the inlet hose

Connecting to a threaded water tap

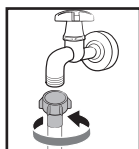

1. Connect the water hose to the water tap, and then turn the connector clockwise as shown.

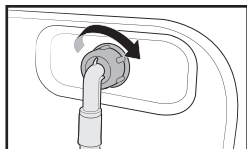

2. Connect the other end of the water hose to the inlet valve on the back of the washing machine. Turn the hose clockwise to tighten.

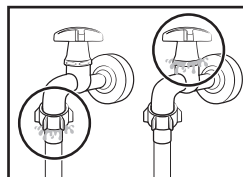

3. Open the water tap and check if there are any leaks around the connection areas. If there are water leaks, repeat the steps above.

Installation

NOTE

- If there is any leakage with hose after the connection, then repeat the steps to connect inlet hose.
- Do not bend the hose.
- Check for inlet hose connection carefully before using the washer each time.

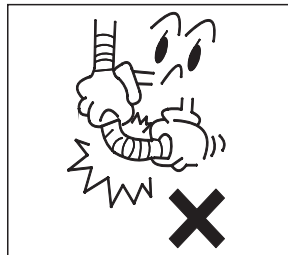

■ Connect the drain hose

- The drain hose shall be placed at a height of 65-100cm above the floor, otherwise, it can cause poor drainage.
- You can use the supplied drain hose support bracket to loop the drain hose down into the wall, standpipe or laundry tub.
- Take care to ensure all hose connections are tight.

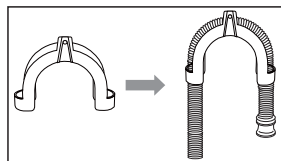

NOTE

- The end of the drain hose cannot be immersed in water for the washer to work properly.

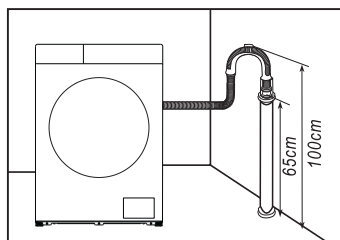

■ Connect the power

- As the maximum current through the unit is 10A when you are using its heating function, please make sure the power supply system (current, power voltage and wire) at your home can meet the normal loading requirements of the electrical appliances.
- Please connect the power to a socket which is correctly installed and properly earthed.
- Make sure the power voltage at your plate is same to that in the machine's rated voltage.
- Power plug must match the socket.
- Do not use a power board or extension lead.
- Do not connect and pull out plug with wet hands.
- When pulling out the plug, hold the plug tightly and then pull it out. Do not pull the power cord forcibly.
- Any electrical components (plug, power cord etc.) must be replaced by a certified agent or qualified service personnel.

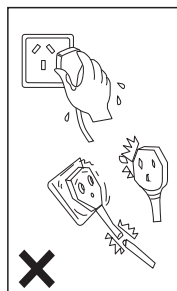

Operations

■ Sort clothes

Please read this recommendation carefully to avoid the risk of damaging clothes.

1. Do not load clothes over the rated load capacity.
2. Sort the laundry by colour and by care label.
Most garments have a textile care label in the collar or side seam.
3. Make sure all the pockets are empty, Foreign objects (e.g. nails, coins, paper clips, etc.) can cause damage to garments and components in the machine.
4. Close any zips, fasten hooks etc. before washing.
5. For clothes to be washed, they should be sorted according to color. Dark clothes should not be washed with light clothes especially.
6. Badly soiled areas, stains etc. should be pretreated with liquid detergent, stain removers etc.
7. Turn over the clothes which pill easily and have a woolly surface before putting them into the machine.

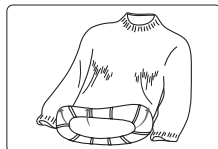
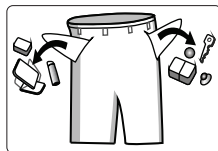

⚠ NOTE: Make sure that no clothes are caught between the door and the seal.

■ Detergent Application

- Detergent out the application drawer.
 - I **Prewash compartment:** Apply prewash detergent or starch.
Used only for prewash programs.
 - II **Main-wash compartment:** Apply main-wash detergent, water softener, soaking detergent, bleach, and/or stain removers.
 - ⊗ **Softener compartment:** Apply additives such as fabric softener. Do not exceed the **max line**.

NOTE

1. Please choose suitable type of detergent for the various washing temperature to get the best washing effect with less water and energy consumption.
2. The amount of detergent/softener used should be added only once at a time. Please refer to the manufacturer's instructions for the dosage of detergent/softener.
3. Do not open the detergent drawer while the washing machine is operating.
4. To prevent the compartment clogging, concentrated or highly-enriched agents (fabric softener or detergent) must be diluted with water before being applied.
5. Do not fill liquid level over the MAX indicator.

Operations

■ Washing steps

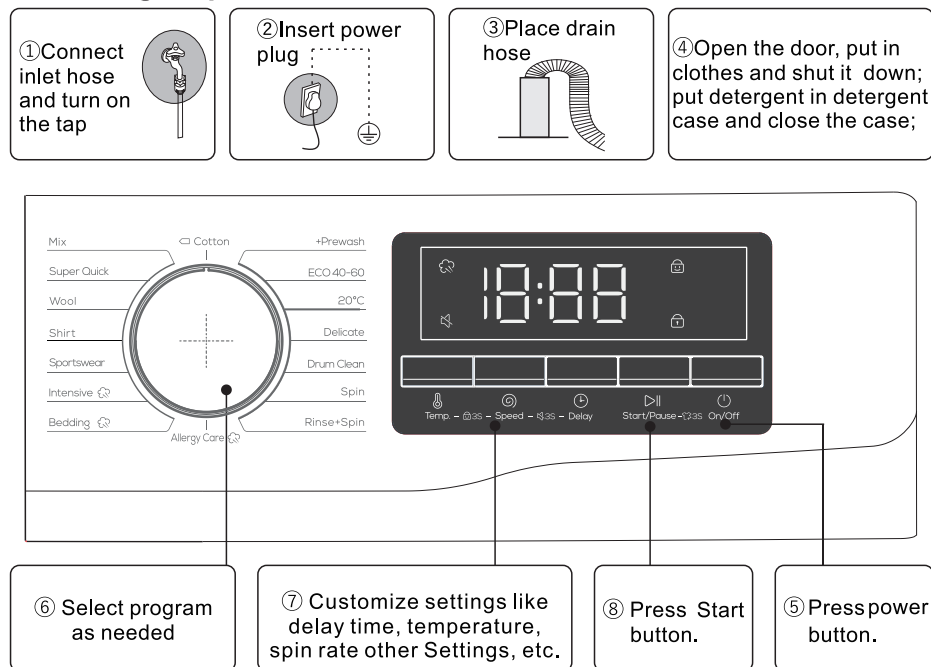

- Press Power **On/Off** to turn on the washing machine.
 - Turn the Cycle Selector to select a cycle.
 - Change the cycle settings (Temperature and Speed, etc.) as necessary.
 - Set Time Delay if you want to finish the wash cycle at the desired time.
 - Press **Start/Pause**.
- To change the cycle during operation
- Press **Start/Pause** to stop operation.
 - Select a different cycle.
 - Press **Start/Pause** again to start the new cycle.

Operations

■ Control panel

* The following illustration is an example of the washing machine control panel. This illustration is for reference only. Actual control panel may slightly differ.

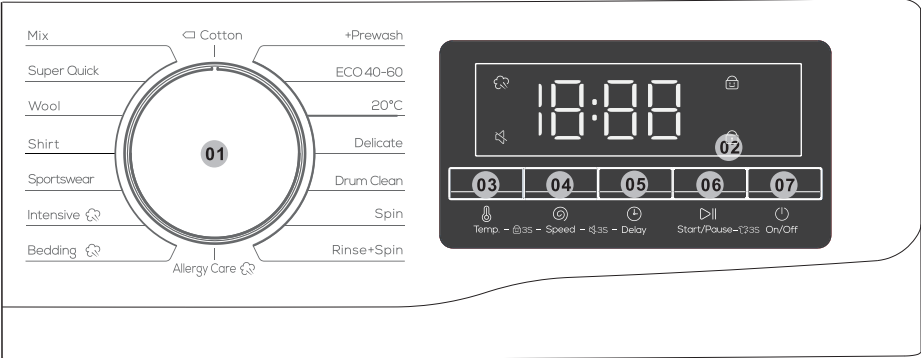

01 Cycle Selector	Turn the dial to select a cycle.
02 Display	The display shows current cycle information and estimated time remaining, or an information code when a problem occurs.
03 Temp.	Press to change the water temperature for the current cycle. Available temperature range depends on the cycle. The selected temperature will be displayed on the display.
04 Speed	Press to change the spinning speed for the current cycle. Available spin speed depends on the cycle. The selected spin speed will be displayed on the display.
05 Delay	Press Delay repeatedly to cycle through the available Delay options (from 3 to 24 hours in one hour increments).
06 Start/Pause	Press to Start/Pause operation. Press the button once to start a cycle. To pause operation, press the button again. You may change the cycle settings and options. To resume paused operation, press the button again.
07 On/Off	Press to turn On/Off the washing machine. If you turn on the washing machine and do not use it for 10 minutes, it will turn off automatically.

Operations

■ Table of Washing Procedures

- Washing efficiency and performance is determined by used detergent quality. Use only machine wash approved detergent.
- If need use specific detergent, e.g. for synthetic and woolen fabric. Mind always detergent manufacturer recommendations.
- Do not use dry cleaning agents such as trichloroethylene and similar products. Choose the best detergent.

Program	Max Load (kg)	Kind of detergent		
	7.5	Universal	Special	Softener
Mix	4	L/P	-	O
Super Quick	2	L/P	-	O
Wool	2	-	L/P	-
Shirt	3	L/P	L	O
Sportswear	3	L/P	-	O
Intensive🌀	4	L/P	-	O
Bedding🌀	4	L/P	L/P	O
Allergy Care🌀	4	L/P	L/P	O
👉 Cotton	7.5	L/P	-	O
+ Prewash	7.5	L/P	-	O
ECO 40-60	7.5	L/P	-	O
20°C	4	L/P	-	O
Delicate	4	L/P	L/P	-
Drum Clean	0	-	-	-
Spin	7.5	-	-	-
Rinse + Spin	7.5	-	-	O

L=gel-/liquid detergent P=Powder detergent O=optional --=no
If using liquid detergent, it is not recommended to activate the time delay.
We recommend by using: Laundry powder 20°C to 95°C; Wool detergent 20°C to 40°C;
*Choose 95°C wash temperature only for special hygienic requirements.

Operations

■ Delay

You can set the washing machine to finish your wash automatically at a later time, choosing a delay of between 3 to 24 hours (in 1 hour increments). The hour displayed indicated the time the wash will finish.

1. Select a cycle. Then change the cycle settings if necessary.
2. Press **Delay** repeatedly until a desired end time is set.
3. Press  **Start/Pause**.

The corresponding indicator turns on with the clock running.

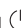
4. To cancel the **Delay**, restart the washing machine by pressing  **On/Off**.
Real-life case

You want to finish a two-hour course 3 hours later from now. For this, you add the Delay option to the current cycle with the 3-hour setting, and press  **Start/Pause** at 2:00 p.m. Then, what happens? The washing machine starts operating at 3:00 p.m., and ends at 5:00 p.m.

■ Steam Wash Icon

If this icon is always lit, it means the Steam Wash function is enabled.

Due to the different configuration of models, some models do not have this configuration, please refer to the actual model.

■ Child Lock

To prevent accidents by children, Child Lock locks all buttons except for  **On/Off**.

- To activate or deactivate the Child Lock function, press and hold **Temp.** and **Speed** simultaneously for 3 seconds.

When Child Lock is activated, the indicator  lights up.

■ Alarm Off

You can turn on or off the sound of the cycle selector and all buttons.

- To turn on or off the sound, press and hold **Speed** and **Delay** simultaneously for 3 seconds. When the sound is off, the  indicator lights up.

■ Door Lock

When the door is not closed or locked normally, the icon is not bright; Lock the door correctly, the icon is always bright.

■ Reload

Long press the  **Start/Pause** button for 3 seconds. After the lock is unlocked, the function of adding clothes in the middle can be started.

Operations

■ Introduction of Other Functions

Unlocking emergency door

- 1、If you want to take out the clothes when there is extended power outage, make sure the water level in the drum is below the safe level, the temperature is under 40 ℃, and the inner drum does not rotate.
- 2、Open the drain pump cover at the bottom right of the front side.
- 3、If the water level in the drum is higher than the bottom edge of the door, make sure the water temperature is below 40 ℃, then remove the rubber pipe plug, and lower the end of the pipe. Let the water flow out until the water level in the drum is lower than the lower edge of the door or no water is flowing out, then put the plug back in pipe, and put the pipe back. (Please be careful with the hot water in the drum to prevent burns)
- 4、Pull down on the rod lightly, when hearing a light sound then open the door and take out or put in the clothes.
- 5、Replace drain pump cover.
- 6、This method can only be used in emergency.

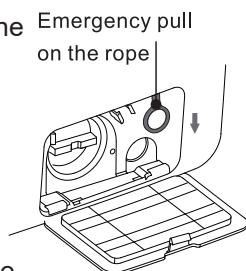

■ Resume Function

• This machine has the resume function in case of power-down. If there is a power failure or plug loose in the process of machine, the machine can remember the working status and resume work when the power is restored.

■ Memory Function (not applicable in some models)

• This machine can remember the latest working process automatically. When you turn on the machine again, the machine remembers the washing process and the settings you made last time (it means the whole working process of the latest washing will be selected by default when the machine starts)

■ Clothes weight Awareness

• In the beginning of the wash cycle, the machine will estimate the weight of the clothes and dispense the detergent automatically (on condition that there is enough detergent in the case), then decide the amount of the water accordingly to achieve the goal of saving water.

■ Unbalance Protection

- When the machine is ready to spin, the washer may take a few times to balance clothes due to a large unbalance.
- If clothes is still unbalanced in the drum after that, the spinning speed can slow down to avoid severe vibration.
- If there not enough clothes in the machine, the machine may not spin due to the unbalance protection, then you should add more clothes in the machine to make it to spin.

Operations

Drum lamp (not applicable in some models)

• At the beginning of the program, at the end of the program and at the pause of the washing state, the lamp of the washing machine drum will be lit. You can observe the situation of the clothes in the washing machine.

Note: Product function and specification may vary from this description, please take note of the actual specification of your model.

Maintenance

Proper maintenance on the washing machine can extend its work life.



Before your maintenance starts, please do pull out the power plug or disconnect power and close the tap.

■ Clean internal drum

The rust left inside the drum by the metal articles shall be removed immediately with chlorine-free detergents. Never use steel wool.

■ Clean surface

1. If there is any water overflow, use the dry cloth to wipe it off immediately.
No sharp items are allowed to strike the washer.
2. The surface can be cleaned with diluted non-abrasive neutral detergents when necessary.

■ Clean the drain pump

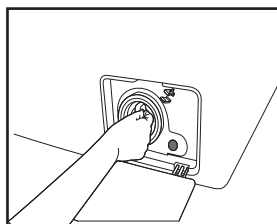
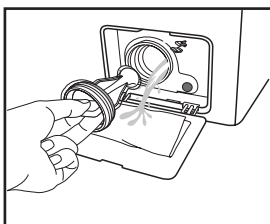
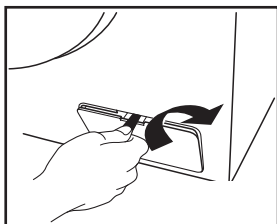

1. Open the filter cover with tools such as coins according to the direction of the graphic;
2. Unscrew the filter and pay attention to the remaining water, taking out any foreign material from the drain pump filter;
3. Reinstall the filter.

Maintenance

■ Clean Inlet valve filter

Clean the mesh filter of the water hose once or twice a year.

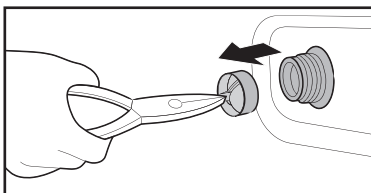
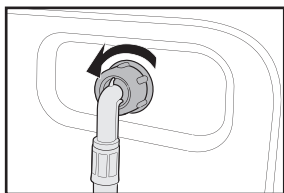

1. Turn off the washing machine, and unplug the power cord.
2. Close the water tap.
3. Loosen and disconnect the water hose from the back of the washing machine. Cover the hose with a cloth to prevent water from gushing out.
4. Use pliers to pull out the mesh filter from the inlet valve.
5. Submerge the mesh filter deeply in water so that the threaded connector is also submerged.
6. Dry the mesh filter completely in the shade. Reinsert the mesh filter into the inlet valve, and reconnect the water hose to the inlet valve.
7. Open the water tap.

■ Clean detergent drawer

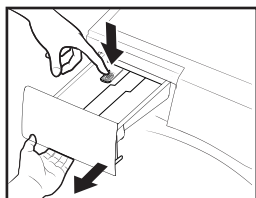

1. While holding down the **release lever** on the inner of the drawer, slide open the drawer.
2. Remove the **Liquid detergent guide** from the drawer.
3. Clean the drawer components in flowing water using a soft brush.
4. Clean the drawer recess using a soft brush.
5. Reinsert the **Liquid detergent guide** to the drawer.
6. Slide the drawer inward to close it.

The illustration is for reference only. Please refer to the actual effect.

■ Recovery from freezing

The washing machine may freeze when it drops below 0°C.

1. Turn off the washing machine, and unplug the power cord.
2. Pour warm water over the water tap to loosen the water hose.
3. Disconnect the water hose, and soak it in warm water.
4. Pour warm water into the drum and leave it for about 10 minutes.
5. Reconnect the water hose to the water tap.

⚠ NOTE

1. When the washing machine is reused, make sure the ambient temperature is above 0°C.
2. If your washing machine is located in the room where it can get frozen easily, please drain the remaining water inside drain hose and inlet hose thoroughly.
3. Please contact a technician if your washer is frozen.

Troubleshooting

TROUBLES	SOLUTIONS
There is some remaining water in the machine	This is normal and is the result of water tests performed at the factory
The washer does not run	Check if the power plug is inserted well. Check if the tap is opened. Check if the “Power” is pressed. Check if the button “Start/Pause” is pressed. Check if the delay feature is activated.
Water leakage	Check and fasten inlet hose. Clean up drain hose and ask a specialized person to repair it when necessary.
Abnormal noise and severe vibration	Check if the transit bolts has been removed. Check if the adjustable legs are adjusted level. Check if the washer is installed on the solid and level floor. Check if there are any batteries or metal articles inside.
Washing efficiency is not satisfactory	Select a proper procedure. Add the proper detergent quantity according to the instructions in detergent package.
The machines buttons will not respond to presses	Check if the “Child-lock” feature has been activated. Press button “Start/Pause” first then press other buttons.
Actual running time of the wash cycle is not corresponded to the display time	Check if clothes in the drum is dispersed well. Check if the water is drain out or inflow well.
The washer fills while draining	Check if the max height of the drain hose is lower than 65cm Check if the drain hose is immersed.

Troubleshooting





















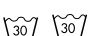

DISPLAY	MEANS	SOLUTIONS
E 1	The washer fill time is too slow	Check if the tap is opened. Check if the water pressure is too low. Check if the inlet hose is blocked.
E 2	Water drainage is too slow	Check if the drain pump is blocked. Contact a technician if necessary.
E 3	Door lock issue	Close the door well again. Check if the clothes is caught between the door and seal. Contact a technician if necessary.
E 4	Water is overflowed	Let the machine drain out water automatically until the water level is suitable for wash procedure. Contact a technician if necessary.
E 5	Electrical motor issue	Please contact a technician.
E 6	Heater issue	Please contact a technician.
E 7	Temperature sensor fault	Please contact a technician.
E 9	Communication failure	Please contact a technician.
E 10	Inverter failure	Please contact a technician.
EP	The procedure running is not corresponded to the cycle that the knob points.	Turn the cycle selector to the cycle corresponded to the procedure working on.

⚠ NOTE

1. Please refer to the actually purchased model for fault display here. Different models have different fault displays
2. When the washing machine gives error codes, make sure to contact our after sales team to repair. We shall not be responsible for any issue caused by unauthorized repair.
3. The display panel shall show “END” for 10 minutes after the cycle finish.
4. For the purpose of improving the performance of the whole washing machine, the appearance and specifications shall be changed without additional notice.

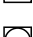
Appendix

■ Fabric Care Label

	Resistant material		Can be ironed at 100°C max
	Delicate fabric		Do not iron
	Item may be washed at 90°C		Can be dry cleaned using any solvent
	Item may be washed at 60°C		Dry clean with perchloride, lighter fuel, pure alcohol or R113 only
	Item may be washed at 40°C		Dry clean with aviation fuel, pure alcohol or R113 only
	Item may be washed at 30°C		Do not dry clean
	Item may be hand washed		Dry flat
	Dry clean only		Can be hung to dry
	Can be bleached in cold water		Dry on clothes hanger
	Do not bleach		Tumble dry, normal heat
	Can be ironed at 200°C max		Tumble dry, reduced heat
	Can be ironed at 150°C max		Do not tumble dry

■ Electrical Warning

To avoid fire, electrical shock and other accidents, please remember the following reminding:

- Only the voltage indicated in power label can be used. If you are not clear of the voltage at home, please contact the local power bureau.
- When you are using the heating function, the maximum current through the washing machine will reach 10A. Therefore, please make sure the power supply units(current,voltage and cable) can meet the normal load requirements for the machine.
- Protect the power cord properly. Power cord shall be fixed well so that it will not trip anyone or anything nor be damaged and be damaged. Special attention shall be paid to the plug location.
- Do not make the wall-mounted socket overloaded or cable extended. Over loading of the wiring may cause fire or electrical shock. Do not pull out power plug with wet hand.
- To ensure your safety, power plug shall be inserted into an earthed socket. Carefully check and ensure that your socket is properly and reliably earthed.

Appendix

■ Protecting the environment

- The washer is manufactured by recyclable materials. If you decide to dispose of this washer, please observe the local waste disposal regulations. Cut off the power cord so that the washer cannot be connected to power. Remove the door so that small animals and children cannot get trapped inside the washer.
- Do not exceed the detergent quantities recommended in the detergent manufactures' instruction.
- Use stain removal products and blesches before the wash cycle only when strictly necessary.
- Save water and electricity by only washing full loads(the exact amount depends upon the program used).
- Correct Disposal of this Product



This marking indicates that this product should not be disposed with other household wastes throughout the EU. To prevent possible harm to the environment or human health from uncontrolled waste disposal, recycle it responsibly to promote the sustainable reuse of material resources. To return your used device, please use the return and collection systems or contact the retailer where the product was purchased. They can take this product for environmental safe recycling.

NOTE:

Standard programme for the Energy and Water Labelling according to
AS/NZS 2040.1:2005
AS/NZS 2040.2:2005
AS/NZS 6400:2016

WF75P10W

* Cotton, 40°C, 1400rpm, is the default setting and the recommended wash programme for normally soiled 7.5kg cotton load.

** The detergent dosage: 12.5g/kg*7.5kg*80% and anti-sudsing agent is 15g.

*** Detergent dissolvent method: Dissolve the detergent first and pour the dissolved detergent into the machine when the main wash starts.

Australian lay-out test supplement

Supplementary Instructions for Australian Drum Test Fabric laying method

- 1.T-shirt, underpants*2, pillowcase and T-shirt—vertical placement
 - 2.Dishcloth and underpants—horizontal placement
 - 3.Bed sheet
 - 4.Shirt, T-shirt, pillowcase and dishcloth—vertical placement
 - 5.Bath towel*2—horizontal placement
 - 6.T-shirt, pillowcase*2 and shirt—vertical placement
 - 7.Bed sheet
 - 8.Dishcloth, tablecloth and underpants—vertical placement
 - 9.Bath towel*2—horizontal placement
 10. Shirt, underpants and dishcloth—vertical placement
 11. Bed sheet
 12. The tablecloth is placed in the center, and the remaining fabric is evenly distributed to both sides—vertical placement
- Note: Vertical placement is from left to right, while horizontal placement is from the inside to the outside.



TCL Electronics Australia Pty Ltd.

ABN 83 111 032 896

Telephone: 1300 738 149

sales.au@tcl.com

www.tcl.com/au

TCL Electronics New Zealand PTY LIMITED.

NZBN 9429043411917

Telephone: 0800 449 750

service.nz@tcl.com

www.tclelectronics.co.nz